



EUROPEAN YOUTH BOULDERING CUP 2022

CHAMBERY (France)

APRIL 9-10



ORGANISATION

Organiser

French Federation of Sport Climbing (FFME)

Club : Chambéry Escalade (location: 540 rue du Revard, 73000 Chambéry) (GPS details: 45°34'43.8"N 5°54'21.5"E)

Website: <https://chambery-escalade.fr/>

Contact Organiser

General Management FFME
General Management LOC

Émilie GHEUX / e.gheux@ffme.fr / +336 81 77 82 26
Hervé DI DOMENICO / +336 16 92 00 28

vice-president-competition@chambery-escalade.fr

Media, Sponsoring & Communications

Florent KUNCKLER / f.kunckler@ffme.com

OFFICIALS

Jury President	Xavier YVONNET
Chief Route Setter	Julien GRAS
Route Setters	Yohan DECHAMPS Maelys AGRAPART One RS from the European exchange programme

REGISTRATION

Licenses

Only competitors and team officials with a valid IFSC international license are allowed to register for the competition.

IFSC Online Registration System

<https://ifsc.results.info/users/login>

Deadline

The deadline for registration is 15 days before the first day of competition (the "Registration Date") on **25 March 2022 at 11:59 PM UTC+0**.

Registration fees

Euro 25€ for each competitor.

The registration fee will be invoiced by the IFSC Europe to the National Federations.

No cash payments will be done on site.

For the registration, it is necessary for all team managers to show the passports or ID-cards of their competitors.

Confirmation of attendance for delayed arrival

In case a team is not able to make the registration in time due to flight delays or other unpredictable reasons, please contact

François LEONARDON / f.leonardon@ffme.fr / +336 07 17 39 06

Online Technical Meeting:

A representative from each participating Member Federation shall participate to the online Technical meeting.

Date: 30 March 2022

Time: 2:00 PM (CET time)

Link: [Online technical meeting](#)

Technical meeting

The technical meeting will take place at the competition venue on Friday April 8th

VISA

If you need invitations for visa, please fill the form at the following address: <http://www.ffme.fr/visa>

COMPETITION UNDER COVID19 - as of February 23rd 2022 -

During the registration all team members will have to present mandatory:

- **A certificate of vaccination**
 - Since more than 7 days after administration of a second dose of Pfizer/BioNTech or Moderna or AstraZeneca
 - Since more than 28 days after administration of a dose of Janssen
- **Or a proof of recovery**
 - 11 days after your recovery (and subsequent negative test result) and less than six months

The competition will be held under the regulation of the IFSC Addendum (https://cdn.ifsc-climbing.org/images/Website/220126_Addendum_COVID-19_v19.pdf)

All athletes and team officials are recommended to have insurance coverage, covering hospitalization and all other medical coverage if required due to COVID-19 and possible repatriation back to their home country.

The FFME and the IFSC Europe will not be responsible for any of these costs.

TRAVEL INFORMATION UNDER COVID 19

Procedures on how to enter in France (**as of, Februray 23rd 2022**)

Knowing that all European countries are classified in green, refer to the link of the French Ministry for travels information:

<https://www.interieur.gouv.fr/covid-19-international-travel>

HOW TO GET TO CHAMBERY

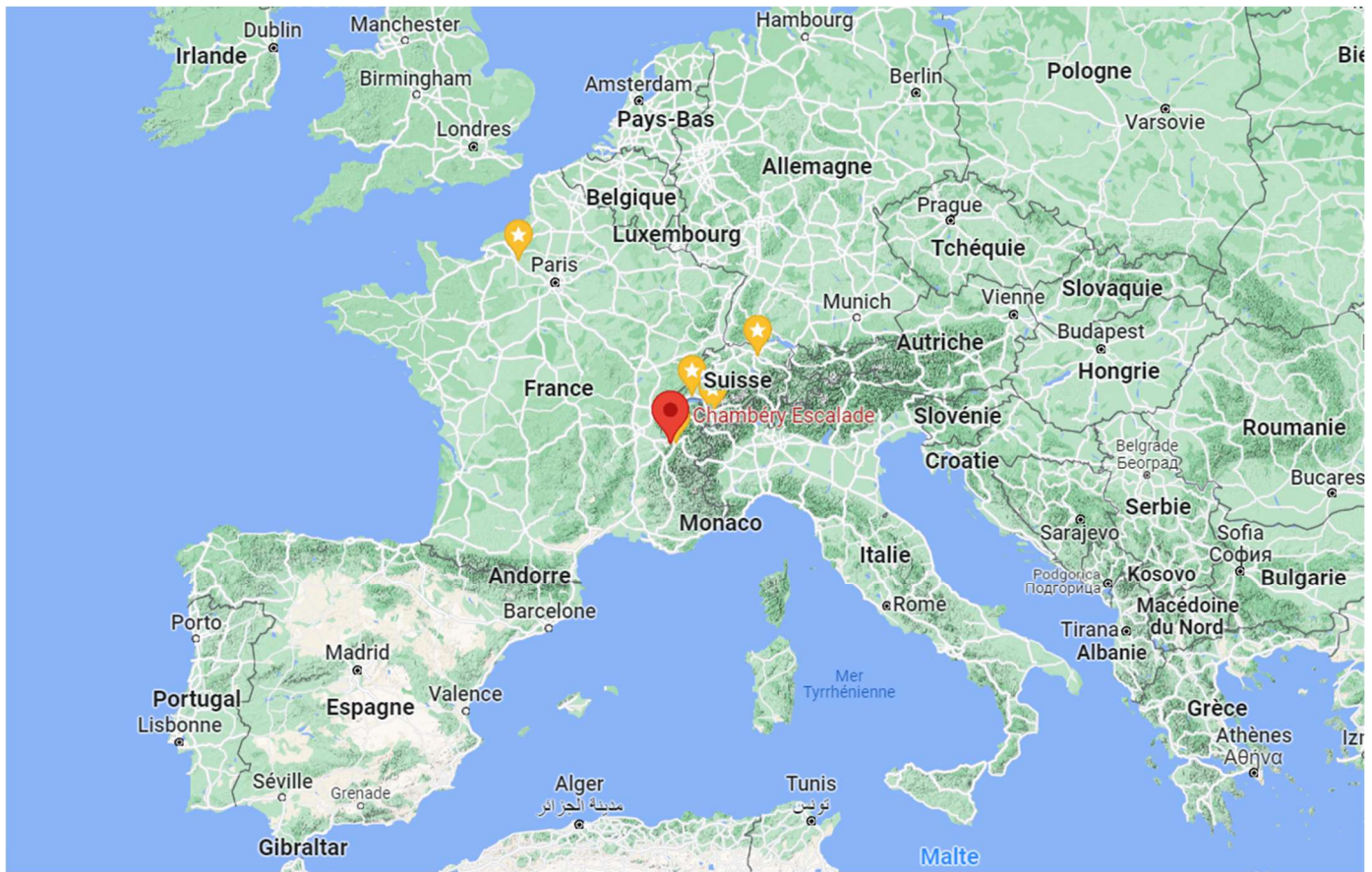

Competition venue Location:

540 rue du Revard, 73000 Chambéry (GPS details: 45°34'43.8"N 5°54'21.5"E)

By car:

Access by A43 or A41, then N201, then exit number 15.

By train:

Numerous high-speed train lines available. The ending-station is Chambéry Challes-les-Eaux.

By plane

The nearest airport is the Chambéry Savoie Mont Blanc airport. It is also possible to come from Lyon Saint Exupéry airport and then take a train to Chambéry Challes-les-Eaux.

ACCOMODATION

Hotel name & website	Distance to the comp / hotel location	Room price (for two) per night
Ibis Budget Chambéry Centre- ville	1,1 km / 391 Av. Alsace Lorraine, 73000 Chambéry	77€ (83€ with breakfast)
Hôtel Mercure	2,1 km / 183 Pl. de la Gare, 73000 Chambéry	69€ (84€ with breakfast)
Hôtel Actuel Chambéry Centre Gare	2,1 km / 1 Av. de la Boisse, 73000 Chambéry	57€ (66€ with breakfast)
Ibis Styles Chambéry Centre Gare	2,6 km / 154 Rue Sommeiller, 73000 Chambéry	62€ with breakfast
B&B hôtel	3,1 km / 204 Rue Dr Vernier, 73000 Chambéry	62€ (70€ with breakfast)

For more information and other hotels, please contact the Tourist Office of Chambéry :

Location: 5 Bis Pl. du Palais de Justice, 73000 Chambéry

Tel: +334 79 33 42 47

Email: <https://www.chamberymontagnes.com/accueil/contact-ot-chambery-montagnes/>

COMPETITION VENUE

Location: 540 rue du Revard, 73000 Chambéry (GPS details: 45°34'43.8"N 5°54'21.5"E)

Access map of the boulder gym:

CHAMBÉRY-ESCALADE
RUE DU REVARDEAU | 73000
CHAMBÉRY



Photos of the boulder gym:

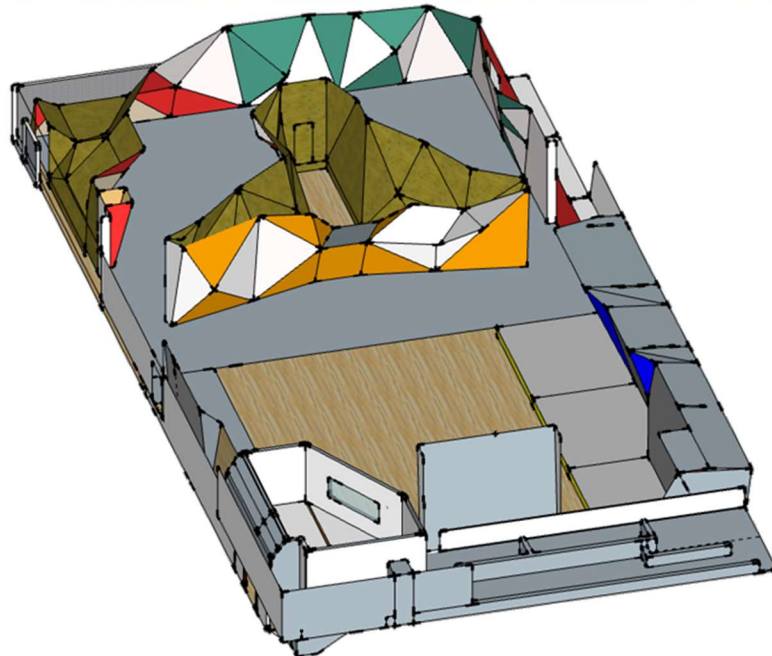



STREAMING

The event will be broadcast online (qualifications and finals).

The link will be available on our website (<https://chambery-escalade.fr/>) and our social networks (instagram <https://www.instagram.com/chamberyescalade/> & facebook <https://www.facebook.com/chambery.escalade/>).

PROVISIONNAL PROGRAMME (EYC rules 2022 in qualification)

Friday, April 8th

16:00 - 17:00 Welcome and participant's confirmation for U18 and U20
17:45 Technical meeting

Saturday, April 9th

06:30 Warming zone opening
08:00 - 12:30 Qualifications U18 men & women
12:00 Warming zone opening
13:00 – 17:00 Qualification U20 men and women
17:00 – 18:00 Isolation U18 and U20 men and women
18:30 - 20:00 Presentation then finals U18 men and women
20:30 – 22:00 Presentation then Finals U20 men and women
22:15 Podium U18 and U20 men and women

Sunday, April 10th

07:00 - 07:30 Welcome and participant's confirmation for U16
07:00 Warming zone opening
08:30 – 13:00 Qualification U16 men and women
13:00 – 14:00 Isolation U16 men and women
15:00 – 16:30 Presentation then finals U16 men and women
16:45 Podium U16 men and women